

Aluminum Frame Structure Design Software

MISUMI FRAMES Operation Manual Component Placement and Editing

Component Placement and Editing

1:	Aluminum Frame Insertion	P.2
2:	Accessory parts insertion	P.3
3:	Part editing (move/stretch/rotate/information view/copy/delete)	P.4
4:	Product Change	P.5

1: Aluminum Frame Insertion

Select Aluminum Frame and easily insert on the screen by selecting and clicking on start and end points.

Brackets and other fastening parts are also Automatic placement.

Operating Procedure

(1) Aluminum Frame Selection (2) Placement

Select desired frame from "Aluminum Frame" in Insert menu.

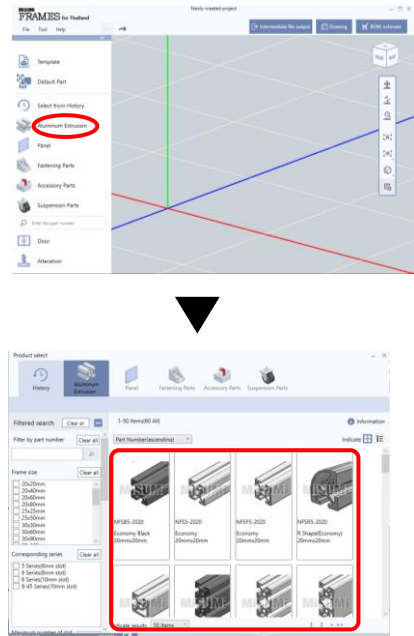

Click start and end points, then click place Aluminum Frame

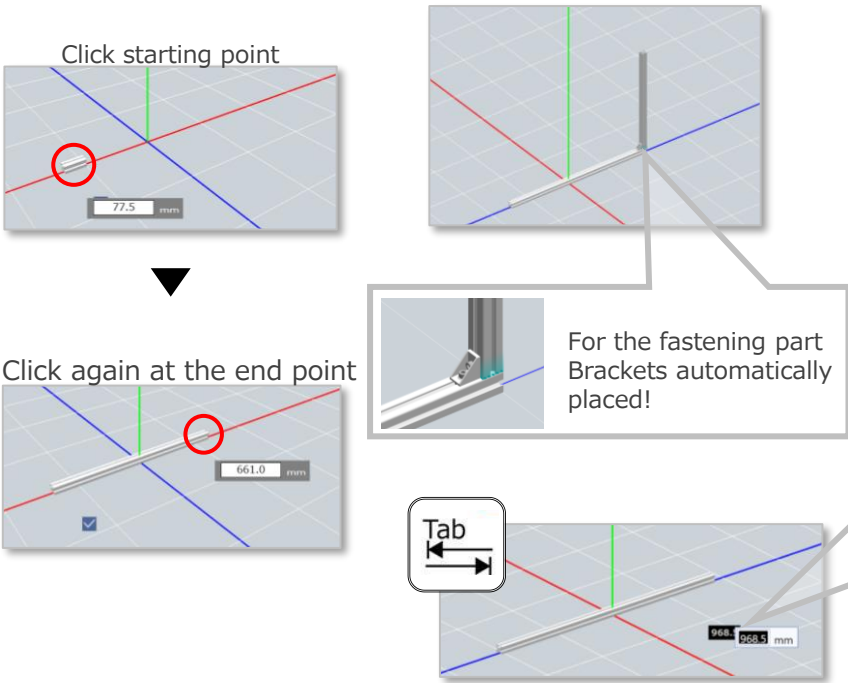

(3) Completion

Click "Finish" button to exit placement mode

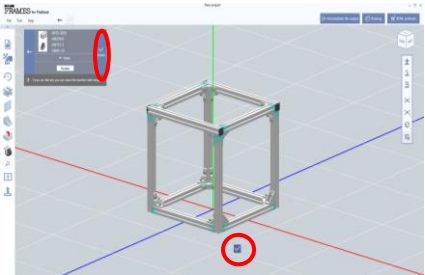

You can specify length dimension of Aluminum Frame, by pressing "Tab" key on your keyboard and manually inputting desired length value.

- Hint -

The placement of products is supported by 3 different color displays.

(1) Blue
Correctly fastened part

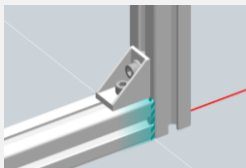

(2) Orange
Locations to be adsorbed in alignment

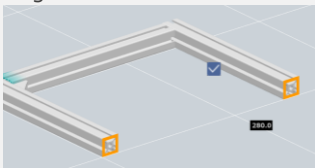

(3) Red
Error location

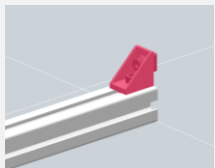

2: Accessory parts insertion

Various accessory parts for design such as Frame cap/Slot cover/Handle/Hinge/Magnetic catches, etc. are available.

It can be selected and arranged from the screen same as Aluminum Frame placement.

Operating Procedure

(1) Accessory Parts Selection

Click on "Accessory Parts" from Insert menu, then select a desired product.

Example: Frame cap selection screen

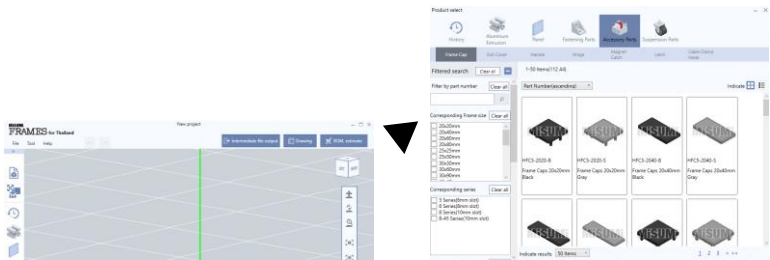

Example: Handle selection screen

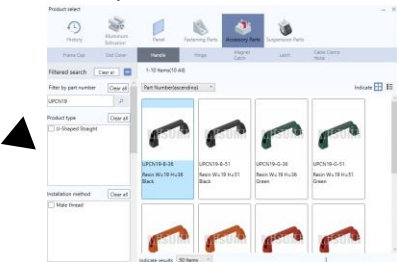

(2) Placement

Intuitive product placement is possible according to various placement methods.

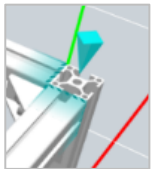
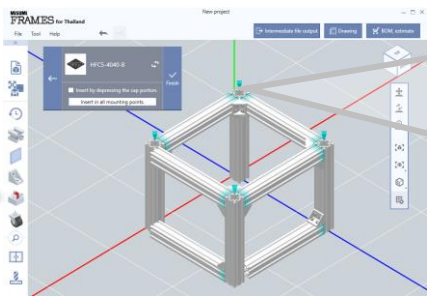

Triangular pyramid mark will be shown on possible placement locations. Click on Triangular pyramid mark to place Frame cap.

Or click again to remove Frame cap.

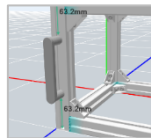
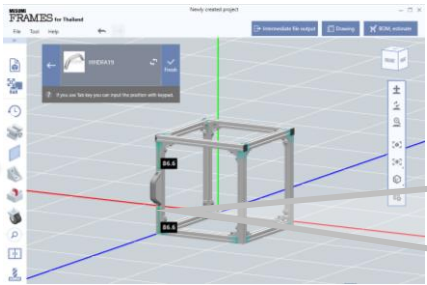

Click to place Handle where available for placement.

- Hint -

Frame caps can be installed by recessing cap thickness.

[How to change]
When placing Frame caps, tick in a box ☒ Insert by depressing the cap portion. on the upper left of screen.

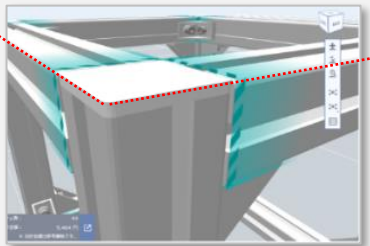

6: Part editing (move/stretch/rotate/information view/copy/delete)

With FRAMES, the model number automatically follows as you edit the product.

No troublesome model number management or modification work is required.

Operating Procedure

(1) Change the range of products by using mouse

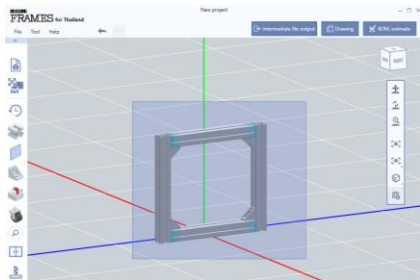

(2) Select a function from Part Edit Tool menu.

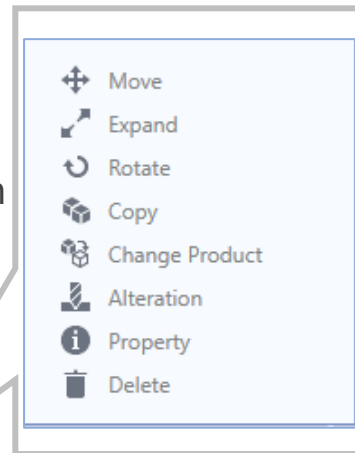
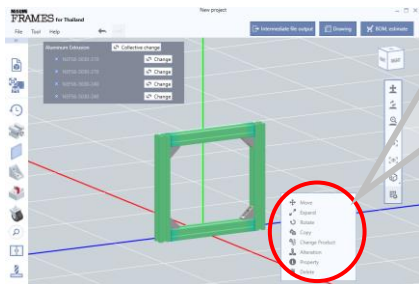

- Hint -

Various shortcut keys are also available for set up.

[How to check/setup]
Click on "File" menu in the upper left corner of the screen
→ Select Configuration
→ Select Shortcut Key

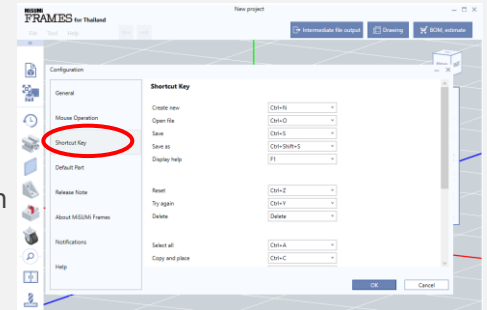

Movement

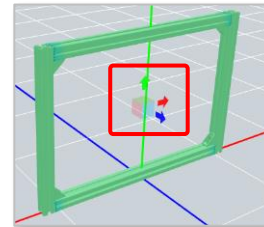

After specifying the direction of movement
Move by mouse operation

Expansion and Contraction

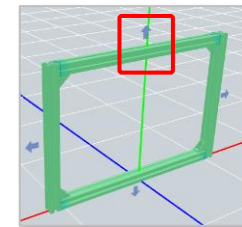

After specifying the direction of expansion and contraction
Expansion and contraction by mouse operation
(Full length and differential can be selected)

Revolution

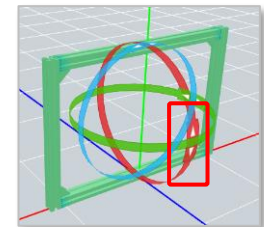

After specifying the direction of rotation
Rotate by mouse operation

Copy and Place

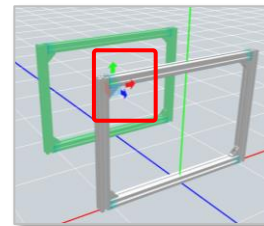

After specifying the placement direction
Placement by mouse operation

Product Information Details

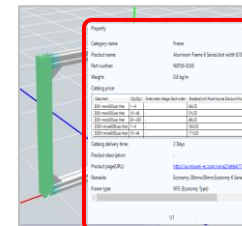

Selected Product Information
Screen activated

Deletion

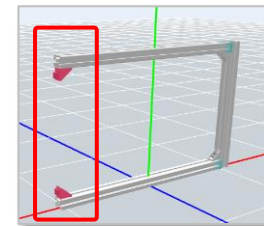

Delete selected parts

Easy to change the placed products whether single item or multiple items.

Operating Procedure

(1) Click on "Change Product

After selecting the product, click "Change Product" in the Part Edit Tool box.

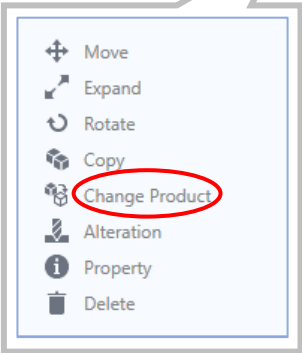
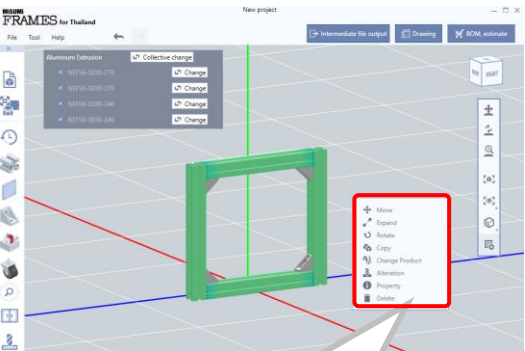

(2) Select products

Select the product you would like to change, and the product selection screen will appear. After selecting the desired product, click "Apply".

Example: If you would like to change the bracket

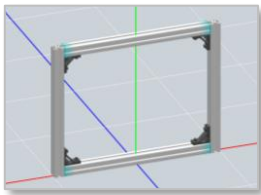
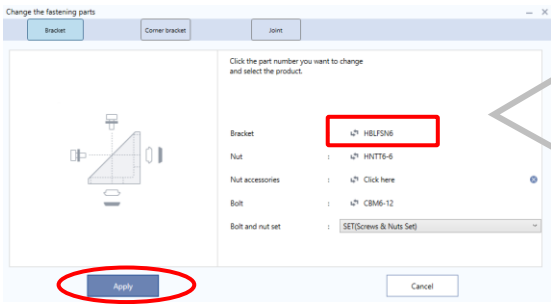

Change Complete

- Hint -.

You can change multiple products at once If they are the same products.

After selecting a product, click on "Collective change" button on the products list screen. Then, selecting the desired product, and click "Apply".

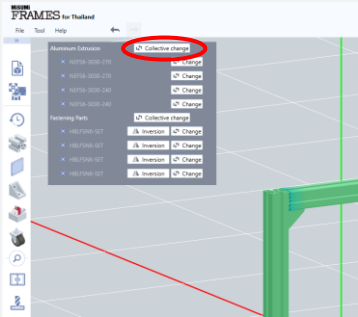

Bracket Selection Screen

